



## Stonefield Place, Hastings TN34 1QH

Offers in excess of £235,000



A beautiful and charming TWO BEDROOM SEMI-DETACHED HOUSE set in an enviable position, in the HEART OF THE QUEENS QUARTER which is known for its antique stores, trendy eateries and bars. It's a VIBRANT NEIGHBOURHOOD and is ideally positioned only a short stroll from Alexandra Park, the beach and Hastings town centre and mainline railway station which benefits from connections to London. The accommodation here has been RECENTLY REFURBISHED with the ground floor arranged as a BRIGHT LIVING ROOM with a BAY WINDOW and stairs rising to the first floor. The CONTEMPORARY FITTED KITCHEN DINER sit to the rear of the property, enjoying high gloss units offering ample storage and worktop space, providing access to the small COURTYARD GARDEN making the perfect spot to dine al fresco. The first floor houses two bedrooms, together with a MODERN FAMILY BATHROOM where there is a bath with shower and screen over. The LOFT ROOM offers great storage and a versatile space. Situated in a SOUGHT AFTER LOCATION and being sold with NO ONWARD CHAIN this fantastic property would make the PERFECT FIRST TIME OR FAMILY HOME.

**Stone Field Place, TN34**  
 Approximate Gross Internal Area = 63.2 sq m / 681 sq ft

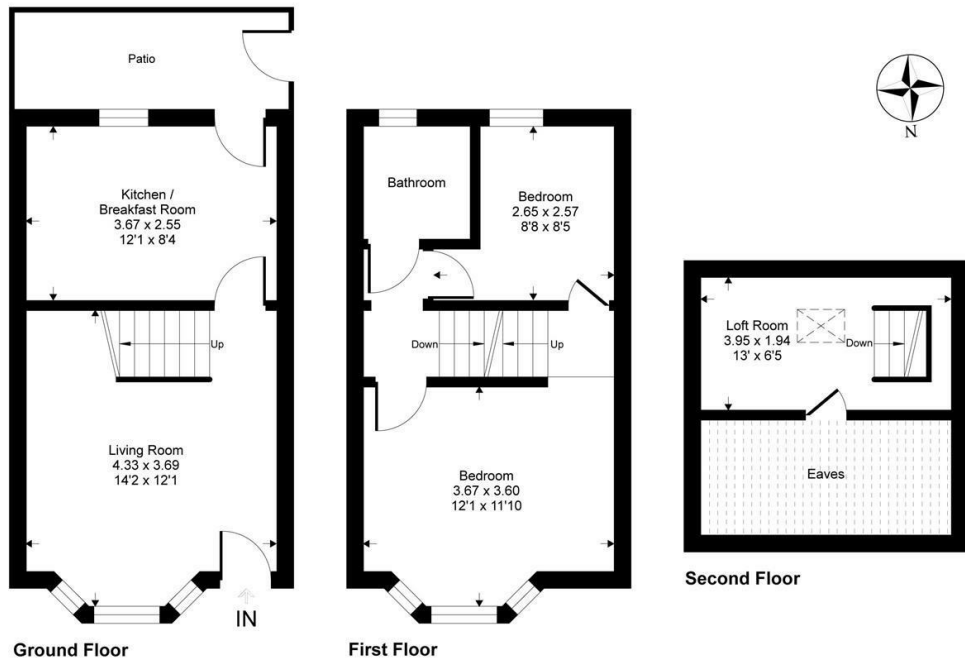

This floor plan is for representation purposes only as defined by the RICS code of Measuring Practice (and IPMS where requested) and should be used as such by any prospective purchaser. Whilst every attempt has been made to ensure the accuracy contained here, the measurement of doors, windows and rooms is approximate and no responsibility is taken for any error, omission or mis-statement. Specifically no guarantee is given on the total area of the property if quoted on the plan. Any figure provided is for guidance only and should not be used for valuation purposes.  
 Copyright Casaphoto Ltd. 2026 - Produced for MADE

